

# T 1 S R 2 W

T. 1 R. 2 W. Sand District East of the Island of New Orleans and West of Pearl River



Table of Contents Public Land

No of Contents Section in acres	Quality of the Public Land
24 416.20	Very good timber oak, beech and bay.
31 200.00	Good timber oak, beech and bay.
43 122.21	Very good timber oak, beech and bay.
44 199.21	Very good timber oak, beech and bay.
160.51	do

Table of Contents

Claimant's name	No of Contents Section in acres	Claimant's name	No of Contents Section in acres
John Davis	1 B18 17.00	Joseph M. Neal	21 A 516.11
Robert Davis	2 A 106.75	Judith Lawrence	22 B36 222.11
Robert Davis	3 A 57.00	Charley W. Mickin	23 B67 645.00
Woodruff Taylor	4 A 145.25	Susannah Gortley	25 A 22 27.11
J. H. Broder	5 A 216.25	William Alexander	26 A 215 217.11
John Brown	6 A 390.25	Anthony Caughley	27 A 49.11
Adam Palmer	7 A 18.25	Thomas Gray	28 A 277 770.25
Heoff & Hill	8 A 902.25	William J. Hamilton	29 A 127.25
Robert M. Coustano	9 A 2 20.25	Robert Ferguson	30 B18 17.00
Samuel P. Silwaite	10 A 650.25	Charles Colwell	32 A 1 22.11
Broder & Coustano	11 A 519.25	Albert Piper	33 A 37 37.11
Robert M. Coustano	12 A 4 37.25	Martha Thompson	34 B11 31.25
Lewis Davis	13 A 2 20.25	William J. Hamilton	35 A 1 27.25
Lewis Davis	14 A 19 19.25	Catharine Turnbull	36 A 2 20.11
Adam Palmer	15 A 20 20.25	Thomas Gray	38 A 49 49.11
John S. Sobell	16 A 21 21.25	Thomas Gray	39 A 126 126.11
William Lemmon	17 A 27 27.25	Catharine Turnbull	40 A 2 20.11
Chemiah Palmer	18 B18 17.00	Margaret Hodgson	41 A 20 20.11
Josias Carter	19 B17 17.00	John Sterling	42 B17 17.00

The Township lines were surveyed in 1827 by George Daugherty, Deputy Surveyor, and the Public Land was surveyed in 1826 by John H. Campbell, Deputy Surveyor.

John P. Hunter, Principal Deputy Surveyor  
November 5th 1827

# T.1S.-R.2W. GREENSBURG DISTRICT, LA.

Rec'd with letter of Apr 24/51 no. 4766 B.  
see Meanders with diagrams & acct.

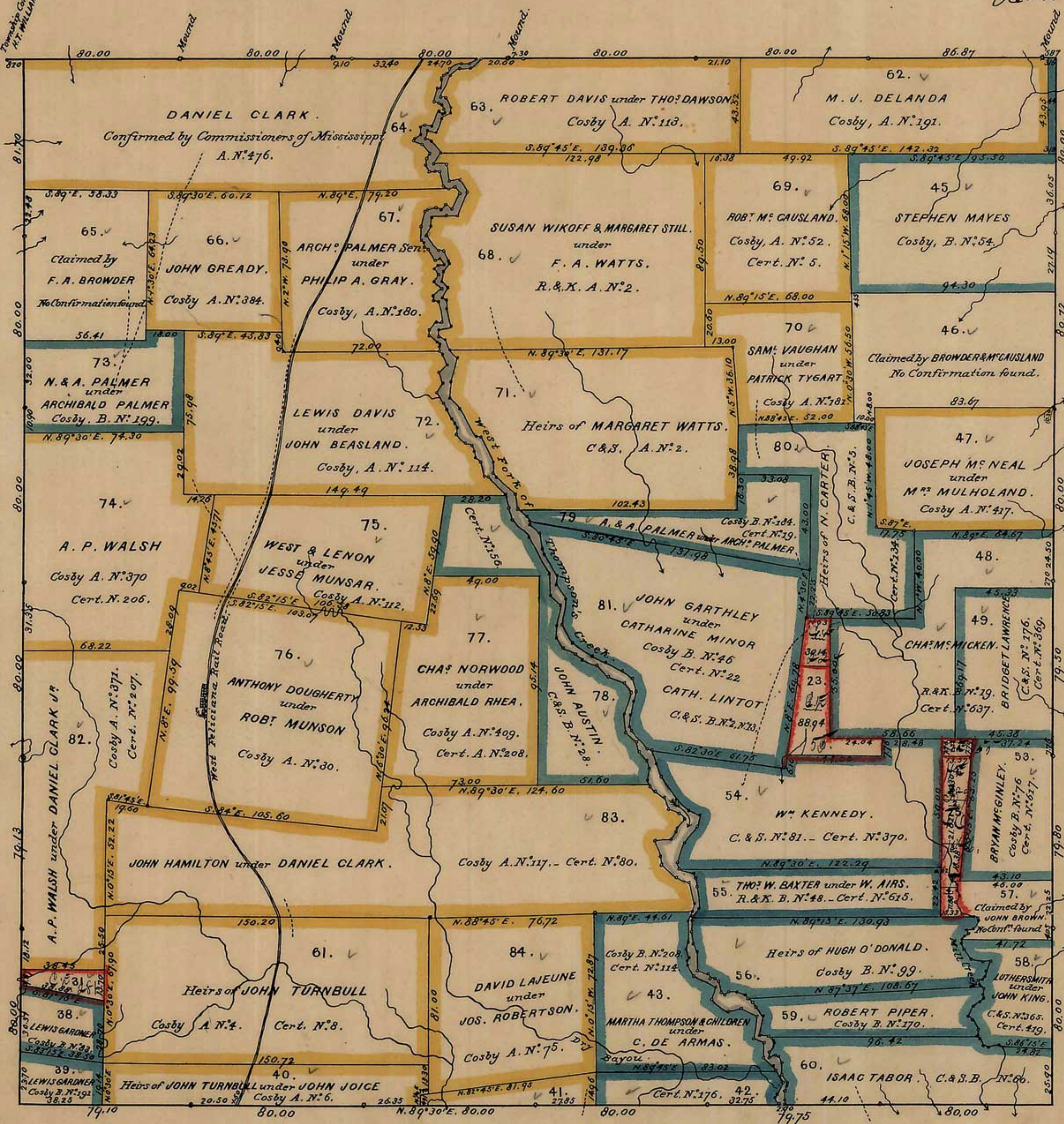

TABLE OF CONTENTS.													
PUBLIC LAND.													
Section	Area	Section	Area	Section	Area	Section	Area						
23.	119.08	24.	10.80	25.	77.18	31.	41.52						
Total of Public Land. 248.58 Acres.													
PRIVATE CLAIMS.													
Sec.	Names.	REPORT.				Area	Sec.	Names.	REPORT.				
		Name	Date	N°	Cert.				Name	Date	N°	Cert.	Area
38.	Lewis Gardner.	Cosby	1813	B.	83.	118.17	63.	Robert Davis under Tho. Dawson.	Cosby	1813	A.	213.	595.67
39.	Lewis Gardner.	"	"	B.	791.	81.92	64.	Daniel Clark Conformity Com. of Mississippi.	A.	476.	"	1152.89	
40.	Heirs of John Turnbull under John Joice.	"	"	A.	6.	303.19	65.	Claimed by F. A. Browder.	No Confirmation found.			399.08	
41.	Margaret Madam under Mr. Cook.	"	"	A.	399.	110.	66.	John Gready.	Cosby	1813	A.	384.	397.98
42.	John Kitting under Matthew & Fallon.	"	"	"	"	374.	67.	Arch. Palmer under Philip A. Gray.	"	"	A.	280.	334.30
43.	M. Thompson & Children under E. De Armas.	Cosby	1813	B.	208.	123.	68.	W. H. Hill under J. R. Watts.	R. & X.	1825	A.	2.	1085.68
44.	William Harris.	"	"	"	"	187.	69.	Robert M. Causland.	Cosby	1813	A.	52.	459.53
45.	Stephen Mayes	Cosby	1813	B.	54.	601.04	70.	Sam. Vaughan under Patrick Tygart.	"	"	A.	281.	4.
46.	Claimed by Browder & M. Causland	No Confirmation found.				509.04	71.	Heirs of Margaret Watts.	C. & S.	1820	A.	2.	900.32
47.	Joseph M. Neal under M. Mulholland	Cosby	1813	A.	417.	468.21	72.	Lewis Davis under John Beasland.	Cosby	1813	A.	114.	15.
48.	Charles M. Mickon	R. & X.	1825	B.	19.	637.	73.	M. A. Palmer under Arch. Palmer.	"	"	B.	199.	323.89
49.	Charles M. Mickon	"	"	"	"	313.40	74.	B. P. Walsh.	"	"	A.	370.	206.
49.	Bridget Lawrence } In Conflict.	C. & S.	1820	"	176.	369.	75.	West & Lenon under Jesse Munson.	"	"	A.	212.	581.17
53.	Byron M. Gentry	Cosby	1813	B.	76.	617.	76.	Anthony Dougherty under Robt. Munson.	"	"	A.	30.	1021.45
54.	William Kennedy.	C. & S.	1821.	B.	81.	370.	77.	John Norwood under Arch. Rhea.	"	"	A.	409.	208.
55.	Tho. M. Baxter under W. A. S.	R. & X.	1825	B.	48.	615.	78.	John Austin.	C. & S.	1820	B.	28.	116.95
56.	Heirs of Hugh O. Donald.	Cosby	1813	B.	99.	432.10	79.	Sam. M. Palmer under Arch. Palmer.	Cosby	1813	B.	204.	261.89
57.	Claimed by John Brown.	No Confirmation found.				108.54	80.	Heirs of Nehemiah Carter.	C. & S.	1820	B.	5.	134.
58.	Luther Smith under John King.	C. & S.	1821	B.	419.	173.35	81.	John Smithley under Cath. Minor.	Cosby	1813	B.	46.	22.
59.	Robert Piper	Cosby	1813	B.	170.	197.32	81.	Catharine Lintot.	C. & S.	1820	B.	213.	928.90
60.	Isaac Tabor.	C. & S.	1820	B.	60.	369.53	82.	A. P. Walsh under Daniel Clark Jr.	Cosby	1813	A.	371.	207.
61.	Heirs of John Turnbull.	Cosby	1813	A.	4.	1020.08	83.	John Hamilton under Daniel Clark.	"	"	A.	117.	80.
62.	M. J. Delanda.	"	"	A.	192.	16.	84.	David Lajeune under Jos. Robertson.	"	"	A.	75.	593.04
Total Area of Private Claims 22399.77 Acres.						Total Area of Township 22648.35 Acres.							

### Variation of the Needle

By WILLIAMS ..... 7° 45' E.  
By TROSKOLAWSKI ... 8° 00' E.

There are no field notes of the original survey of the North Boundary on file in this office. The East, South and West Boundaries were originally surveyed by Geo. Dougherty D.S. in the 1<sup>st</sup> and paid for in the 3<sup>rd</sup> qr. of 1821. Secs. 31, 40, 41, 42, 74 & 82 were surveyed by S. M. D. Clark D.S. and paid for in the 3<sup>rd</sup> qr. of 1828. Sec. 39 was surveyed by A. B. Graham D.S. and paid for in the 3<sup>rd</sup> qr. of 1828. The remainder of the Private claims, except sec. 53, 57, 58 & 60, were surveyed by A. W. Draughon, D.S. in the 3<sup>rd</sup> qr. of 1825, were paid for in the 3<sup>rd</sup> qr. of 1828. Secs. 53, 57, 58 & 60 were surveyed and sec. 44, 45, 46, 47, 48, 49, 54, 55, 56 & 59 resurveyed by Seth Kline D.S. in the years 1829, 1833, & 1836 under Contract of February 22<sup>nd</sup> 1840 and were paid for in the 4<sup>th</sup> qr. of 1843. The North Boundary was resurveyed by S. T. Williams D.S. in 1845 under Contract of May 1<sup>st</sup> 1845 and is included in his account approved October 7<sup>th</sup> 1845. The West, South & East Boundaries and all the interior of the Township were resurveyed by Joseph Troskolawski D.S. in the 1<sup>st</sup>, 2<sup>nd</sup>, & 4<sup>th</sup> qr. of 1850 under Contract of May 12<sup>th</sup> 1849, by retracing and reestablishing old lines and corners.

Note. It will be perceived that several claims for which no confirmation has been found have been surveyed and represented upon this map. This is for representation merely and is not intended as a recognition of their validity. The reason why this has been done is that they are represented on the old map of the Township and have been claimed as individual property for many years. - The Surveyor reports no swamp lands in this Township.

The above map has been examined and compared with the approved field notes thereof, now on file in this office, found correct and is hereby approved, with the exception of those claims for which no confirmation has been found.

Survey "Confirmed" by Secy of the Interior see abstract B with Secy's letter of Jan 7/52 - (with exceptions.)

Surveyor General's office of Donaldsonville La. April 24 1851.  
R. W. Boyd.  
Surveyor General, La.

DEPARTMENT OF THE INTERIOR  
GENERAL LAND OFFICE,  
Washington, D. C. August 15, 1902  
I hereby certify that this photo-lithograph is a true and literal amplification of the township plat of survey to which it purports to relate, now on file in this office.  
W. S. Richards  
Acting Commissioner.